

FOR PRINT SIZE 11" X 17"

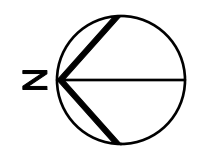
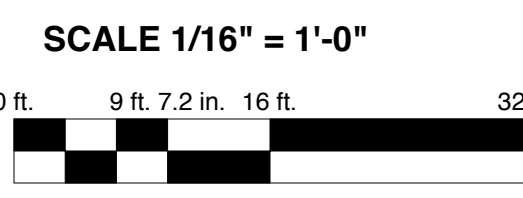

**Lorna Professional Building • first floor**  
 Birmingham, AL 35216

**Collateral Properties**  
 1900 Crestwood Blvd., Suite 300 • Irondale, AL 35210

**Tom Coggin**  
 205-951-1015  
 tcoggin@collateralproperties.com

**Bryan Ratliff**  
 205-951-4488  
 bratliff@collateralproperties.com

No warranty or representation, expressed or implied, is made to the accuracy of the information contained herein. Such information is submitted subject to change in price, errors, omission, and withdrawal without prior notice. **This document is not for construction purposes.**

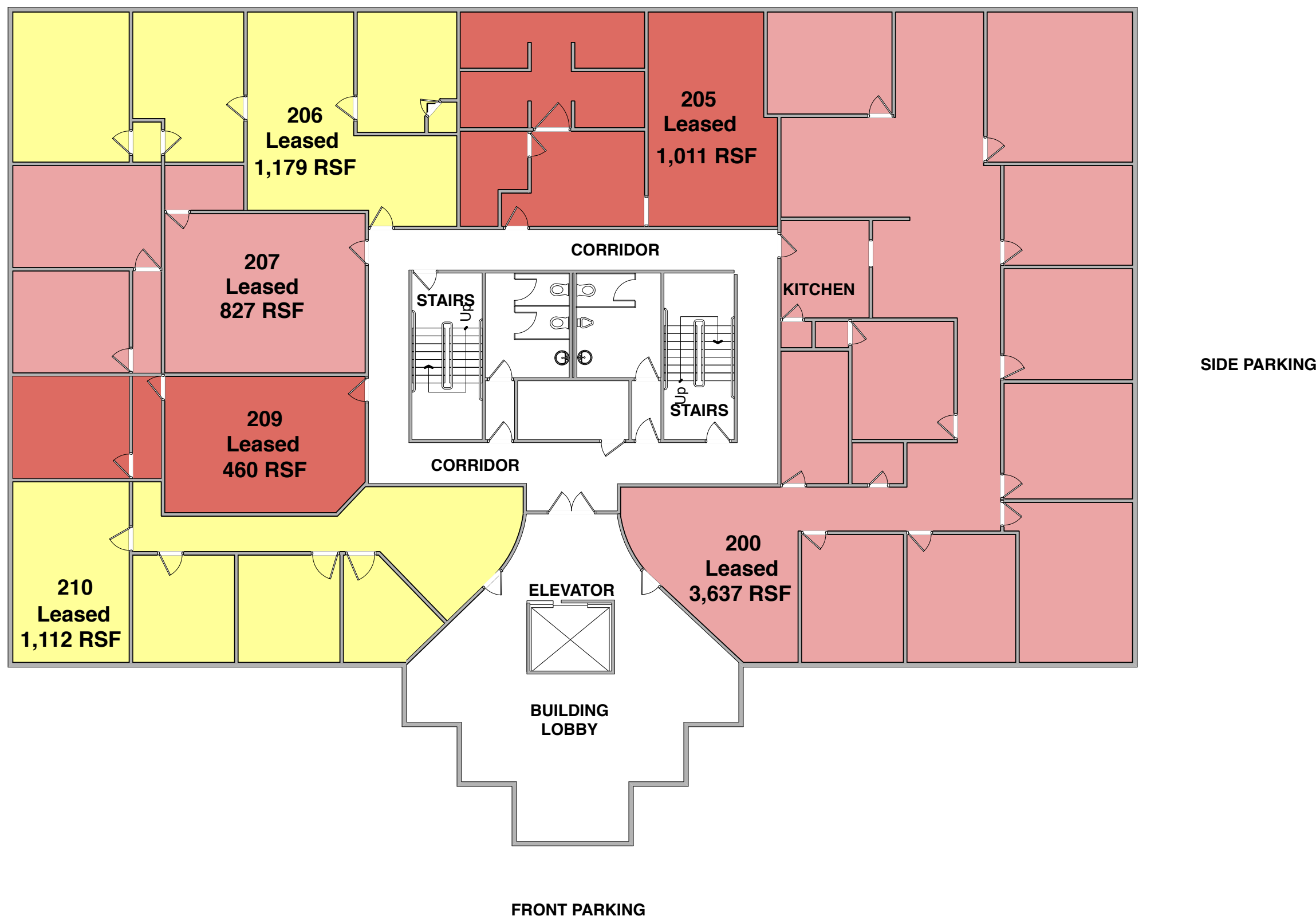

FOR PRINT SIZE 11" X 17"

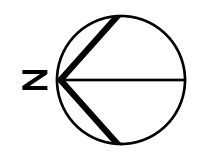
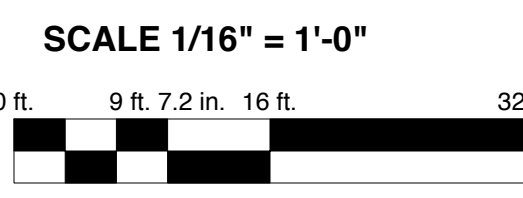

# Lorna Professional Building • second floor

Birmingham, AL 35216

**Collateral Properties**  
 1900 Crestwood Blvd., Suite 300 • Irondale, AL 35210

**Tom Coggin**  
 205-951-1015  
 tcoggin@collateralproperties.com

**Bryan Ratliff**  
 205-951-4488  
 bratliff@collateralproperties.com

No warranty or representation, expressed or implied, is made to the accuracy of the information contained herein. Such information is submitted subject to change in price, errors, omission, and withdrawal without prior notice. **This document is not for construction purposes.**

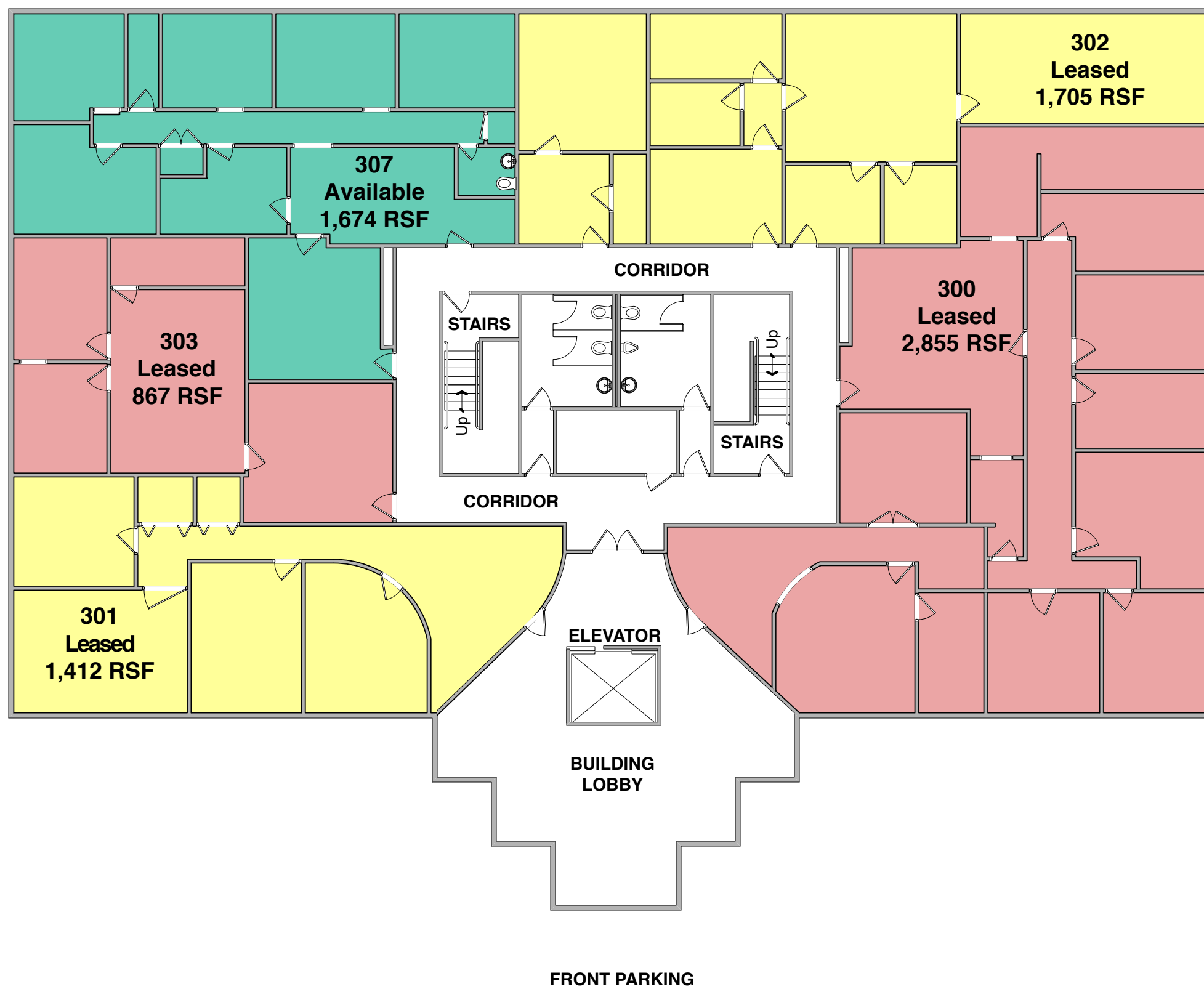

FOR PRINT SIZE 11" X 17"

SCALE 1/16" = 1'-0"

0 ft. 9 ft. 7.2 in. 16 ft. 32 ft.

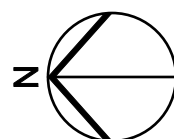

# Lorna Professional Building • third floor

Birmingham, AL 35216

## Collateral Properties

1900 Crestwood Blvd., Suite 300 • Irondale, AL 35210

Tom Coggin  
205-951-1015

tcoggin@collateralproperties.com

Bryan Ratliff  
205-951-4488

bratliff@collateralproperties.com

No warranty or representation, expressed or implied, is made to the accuracy of the information contained herein. Such information is submitted subject to change in price, errors, omission, and withdrawal without prior notice. **This document is not for construction purposes.**