

LORNA PROFESSIONAL

HOOVER, ALABAMA



LEASE

3021 Lorna Road Hoover, AL 35216

AVAILABLE SPACE

1,694 RSF

LEASE RATE

\$18.00 PSF

PROPERTY INFORMATION

- Highly visible
- Easily accessible
- Ample free parking
- Less than a mile from Highway 31
- 1 mile from I-65
- 2 miles from I-459
- Full service building

CONTACT

Tom Coggin
tcoggin@collateralproperties.com
(205) 951-1015

Available Unit	Square Feet
----------------	-------------

207	827
-----	-----

301	2,639
-----	-------

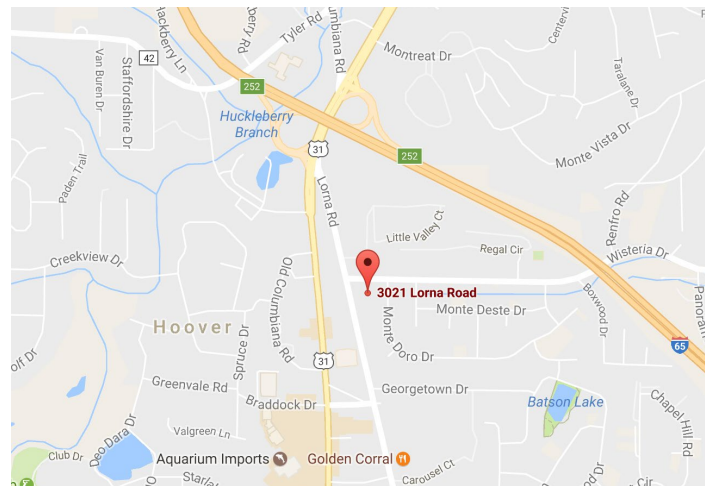

COLLATERAL
PROPERTIES

LORNA PROFESSIONAL

HOOVER, ALABAMA

Floor 1

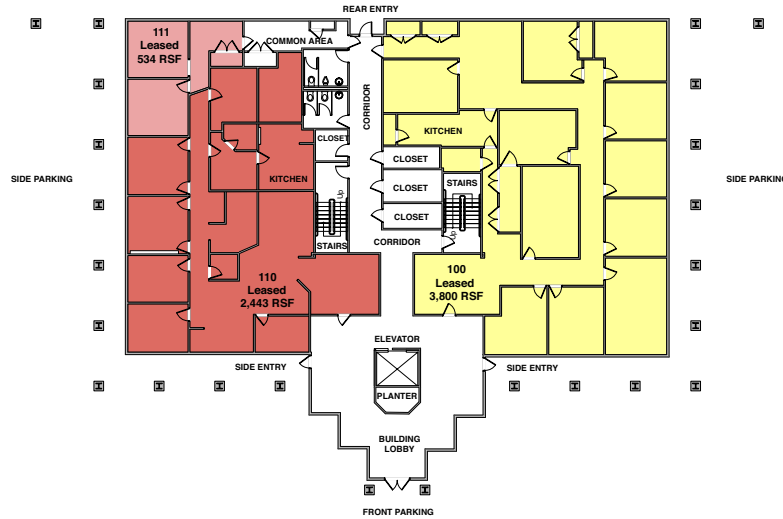

LEASE

3021 Lorna Road Hoover, AL 35216

AVAILABLE SPACE

1,694 RSF

LEASE RATE

\$18.00 PSF

Available Unit	Square Feet
207	827
301	2,639

Floor 2

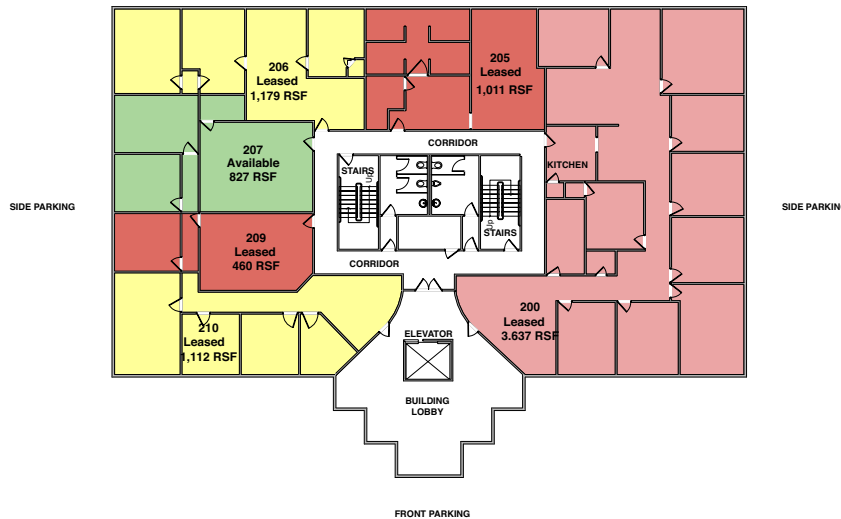

CONTACT

Tom Coggin
tcoggin@collateralproperties.com
(205) 951-1015

**COLLATERAL
PROPERTIES**

For more information and to view other spaces, visit www.collateralproperties.com

LORNA PROFESSIONAL

HOOVER, ALABAMA

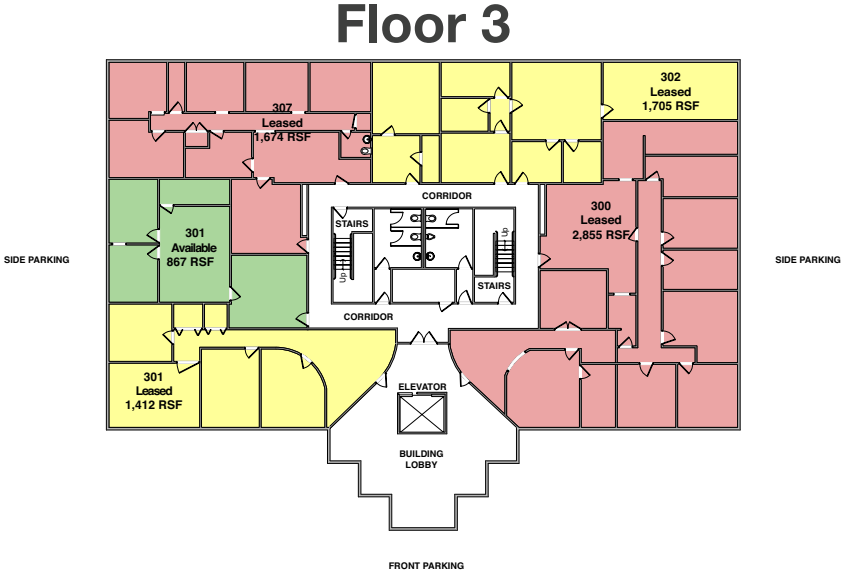

LEASE

3021 Lorna Road Hoover, AL 35216

AVAILABLE SPACE

1,694 RSF

LEASE RATE

\$18.00 PSF

Available Unit	Square Feet
207	827
301	2,639

CONTACT

Tom Coggin
tcoggin@collateralproperties.com
(205) 951-1015

**COLLATERAL
PROPERTIES**

For more information and to view other spaces, visit www.collateralproperties.com