

CRESTBROOK PLAZA

MOUNTAIN BROOK, ALABAMA

AVAILABLE UNIT SQUARE FEET

201	1,126
202	3,035
206	2,345
210	1,656
219	1,732

See Floor Plan on Reverse Side



LEASE

3918 Montclair Road
Mountain Brook, AL 35223

AVAILABLE SPACE

10,200 RSF

PROPERTY INFORMATION

- Located in Mountain Brook
- Less than a mile from Crestline Village
- Easy access to interstate system
- Indoor and outdoor entrances
- No Birmingham occupational tax
- On-site management
- Full service building
- Ample free parking (some covered)
- Adjacent to a post office
- 3 miles from downtown

LEASE RATE

\$18.00 PSF, Full Service

CONTACT

Tom Coggin
tcoggin@collateralproperties.com
205.951.1015

COLLATERAL

PROPERTIES

For more information or to view other spaces, visit www.collateralproperties.com

CRESTBROOK PLAZA

MOUNTAIN BROOK, ALABAMA

LEASE

3918 Montclair Road
Mountain Brook, AL 35223

AVAILABLE UNIT SQUARE FEET

AVAILABLE UNIT	SQUARE FEET
201	1,126
202	3,035
206	2,345
210	1,656
219	1,732

LEASE RATE

\$18.00 PSF, Full Service

EXCLUSIVE AGENTS

Tom Coggin
tcoggin@collateralproperties.com
205.951.1015

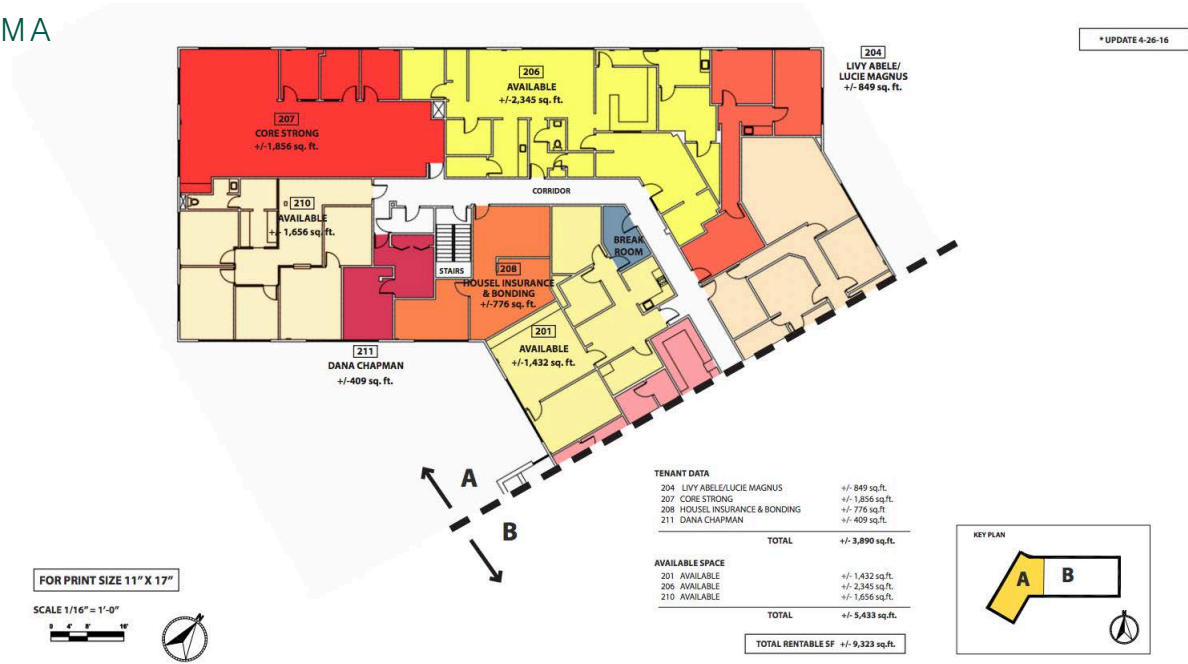

FLOOR 2

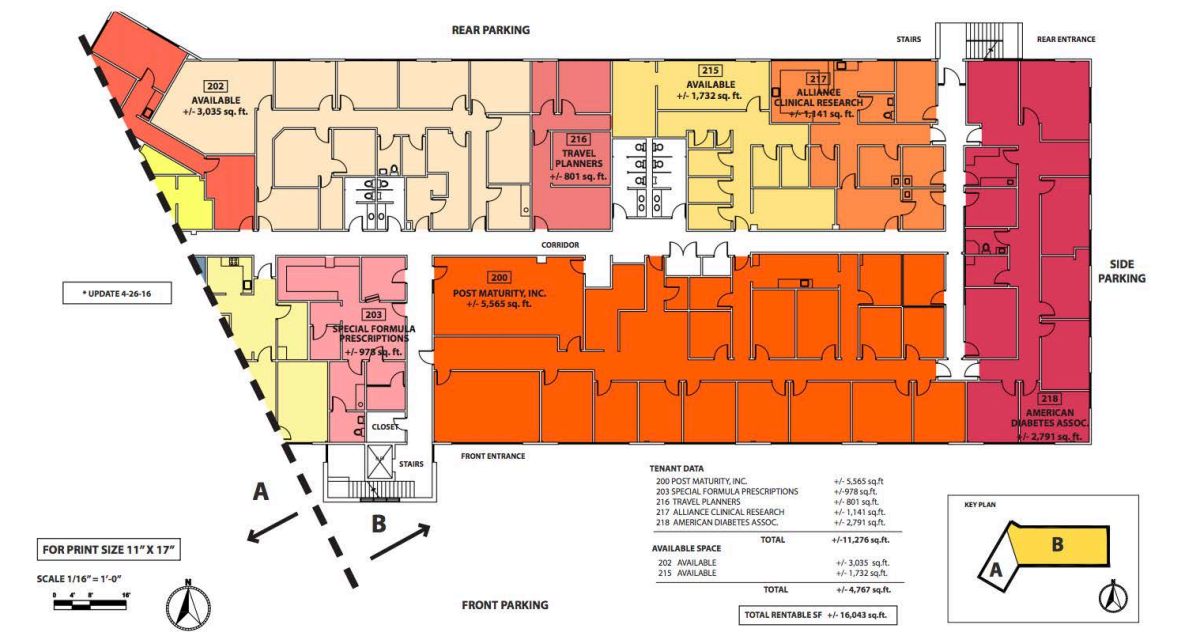

COLLATERAL

PROPERTIES

For more information or to view other spaces, visit www.collateralproperties.com